

DOMINANT[®]

Liquid ant bait

See Side Panel and Back Panel for Directions and Precautions
EPA Reg. No. 64405-23 EPA Est. 81184-FL-3

Active Ingredient:
Sodium tetraborate
Decahydrate (Borax) 5.40%
Other Ingredients: 94.60%
Total 100.00%

KEEP OUT OF REACH OF CHILDREN

DOMINANT[®]

Liquid ant bait

Kills:



SUGAR/SWEET EATING ANTS (EXCEPT PHAROAH, CARPENTER, FIRE, AND HARVESTER), KILLS QUEEN AND COLONY.

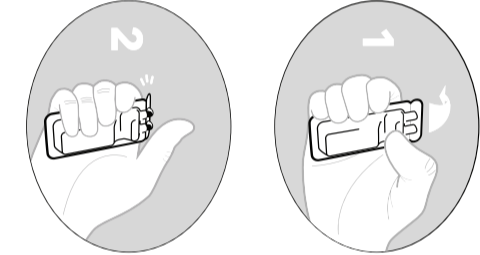

ANT DOMINANT



For Use in and Around (but Not Limited To): Apartments, boats, cafeterias, commercial and cruise ships, dairies, food processing plants, garages, grocery stores, homes, hospitals, hotels, institutional buildings, kennels, military bases, military ships, mills, mobile homes, motels, nursing homes, pet stores, public and private institutions, restaurants, schools, storage areas, supermarkets, theaters, vending machines, warehouses and zoos.

Attracts and Kills All Common Household Ants, Including: Acrobat ants, Argentine ants, big headed ants, cornfield ants, crazy ants, ghost ants, little black ants, odorous house ants, pavement ants, white-footed ants and other sweet-eating ants (except pharaoh, carpenter, fire and harvester ants).

PRECAUTIONARY STATEMENTS
Environmental Hazards: Do not apply directly to water, to areas where surface water is present, or to intertidal areas below the mean-high-water mark. Do not contaminate water when disposing of equipment washwaters or rinsate.
Physical/Chemical Hazards: Do not mix or allow contact with an oxidizing agent. Hazardous chemical reaction may occur.

NOTICE
Read and understand the entire label before using.
Use only according to label directions.

DIRECTIONS FOR USE
It is a violation of Federal law to use this product in a manner inconsistent with its labeling.
Use of this product for the control of bed bugs is prohibited. Applications to carpets are prohibited. Place bait in areas inaccessible to children and pets.

Use Restrictions
Do not contaminate this product with other pesticides. If this product becomes contaminated with another pesticide it will lose its effectiveness. Do not apply directly to food and do not contaminate feed and foodstuff. Do not treat pets with this product. Place stations in areas accessible to insects but inaccessible to children and pets.

To open bait station and expose the ant entry ports, hold one end of the station while bending the snap tab back. Place station in locations where ant traffic is visible.
Application for Food Processing and Handling Establishments, Including Federally Inspected Poultry and Meat Plants: In food areas, only apply product into inaccessible areas.

Do not contaminate food and feed stuffs. Cover or remove any food during application. Do not apply product directly onto a surface where food is prepared, served or stored. Remove any product left visible on a food surface after treatment and wash surface.

In food handling and other areas, record the number and location of bait stations. This product is designed to be used as a residual treatment in an Integrated Pest Management program incorporating good sanitation practices.

Food Areas Include: Serving Areas, such as dining rooms, food storage areas, receiving areas, processing areas, including enclosed systems such as oil and syrup plants, mills and dairies; Packing Areas, including canning, bottling, wrapping and boxing; and Edible Waste Storage Areas. Do not allow product on any surfaces that may be contacted by food. Do not apply when facility is in operation or when food is exposed. Remove any product left visible on a food surface after treatment and wash surface.

Non-Food Areas Include: Bathrooms, locker rooms, offices, maintenance rooms, mechanical rooms, trash rooms, garages, janitorial closets, storage areas after bottling or canning and floor drains leading to sewer entries. In these areas, apply product as labeled for other non-food areas.
For a complete and printable Warranty Disclaimer, please visit www.nisuswarranty.com.

DOMINANT[®]

Liquid ant bait

Storage and Disposal
Do not contaminate water, food, or feed by storage or disposal.
PESTICIDE STORAGE: Store in a cool dry place. Do not store where children or animals may gain access. **PESTICIDE DISPOSAL AND CONTAINER HANDLING:** Nonrefillable Container. Do not reuse or refill this container. **If Empty:** Place in trash or offer for recycling if available. **If Partly Filled:** Call your local solid waste agency for disposal instructions. Never place unused product down any indoor or outdoor drain.



100 Nisus Drive, Rockford, TN 37853
(800) 264-0870

CONTENTS: 30 BAIT STATIONS
NET CONTENTS: 0.37 FL OZ (11ml) each

